

OPERATION MANUAL

VCX-1

Vacuum Coolant Exchanger

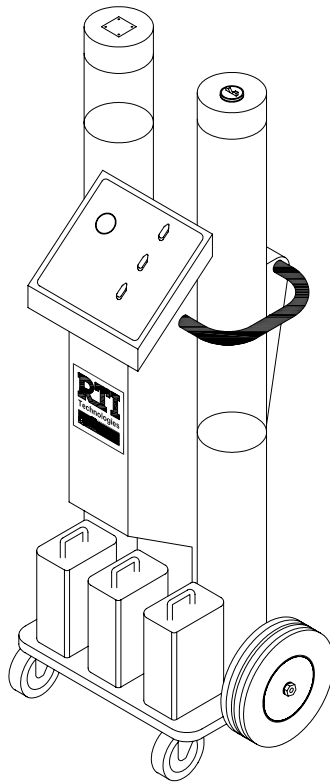

RTI Technologies, Inc

10 Innovation Drive

York, PA 17402

800-468-2321

www.rtitech.com

Manual P/N 035-80924-00 (Rev B)

Table of Contents

Component Description	2
Safety Precautions	3
Home Position	4
Fill New Tank through Hose	5
Fill New Tank through Fill Cap	6
Empty Radiator	7
Special Hookups	9
Fill Radiator	10
Top Off	11
Flush Radiator	12
Empty Waste Tank	12
Empty New Tank	13
Troubleshooting	14
Parts Identification	15
Flow	16

Component Description

Unpack all components and verify quantities per this illustration.

Contact RTI if any items are missing.

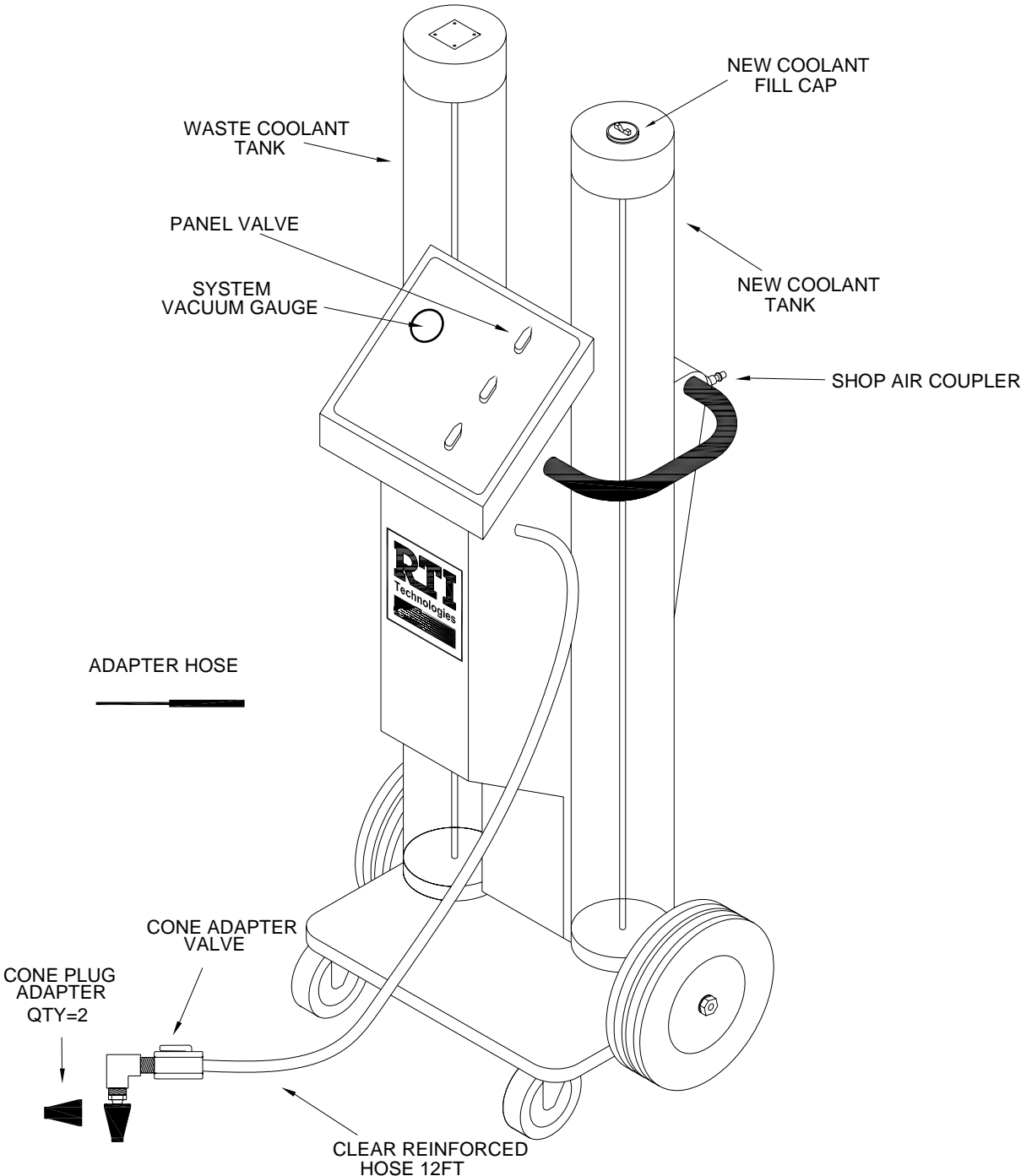

Safety Precautions

WARNING: Failure to follow these precautions can result in serious injury or death.

- Read and understand the Operation Manual completely before operating this unit.
- Always wear proper eye and skin protection when operating and maintaining this equipment.
- Automotive cooling systems can be under pressure and extremely hot. Place a rag over the radiator cap during removal to avoid injury. Use extreme caution when removing caps.
- Coolants are poisonous to people and animals and are also corrosive. Clean up any spills immediately.
- Do not allow waste coolant tank to overflow. Immediately clean up any coolant spills. Damage to the vehicle and equipment can result from the corrosiveness of coolant.
- Continuous monitoring of the coolant exchange process is required.
- If cracks appear in the cylinders, hoses, or adapters these parts must be replaced.
- If leaks occur at the bottom or top of the cylinders the center nut located under the top cover plate will need to be tightened. **(see page 13 for instructions)**
- The cylinders, hoses and adapters are plastic and rubber products and are in contact with oil and chemicals which may lessen their durability. Therefore, when soiled, they should be cleaned with water and a mild detergent. **Caution: Do not clean with thinners, solvents or any other chemical cleaners.**
- Only disassemble or reassemble unit parts when directed by an RTI representative.
- Take precautions to keep clothing, hair, hands, hoses, etc. away from all moving parts of the vehicle.
- Comply with local, state and federal regulations for fluid disposal.
- **Material Safety Data Sheets** (MSDS) must be obtained on all chemicals and placed in a shop file for reference. These are available for down load and printing on the RTI web-site (www.rtitech.com). Go to TECHNICAL HELP and look under Technical Bulletins.

CAUTION: Failure to follow the precautions as outlined in the operation manual can result in damage to the engine, vehicle or equipment which will not be supported or covered under warranty.

Home Position

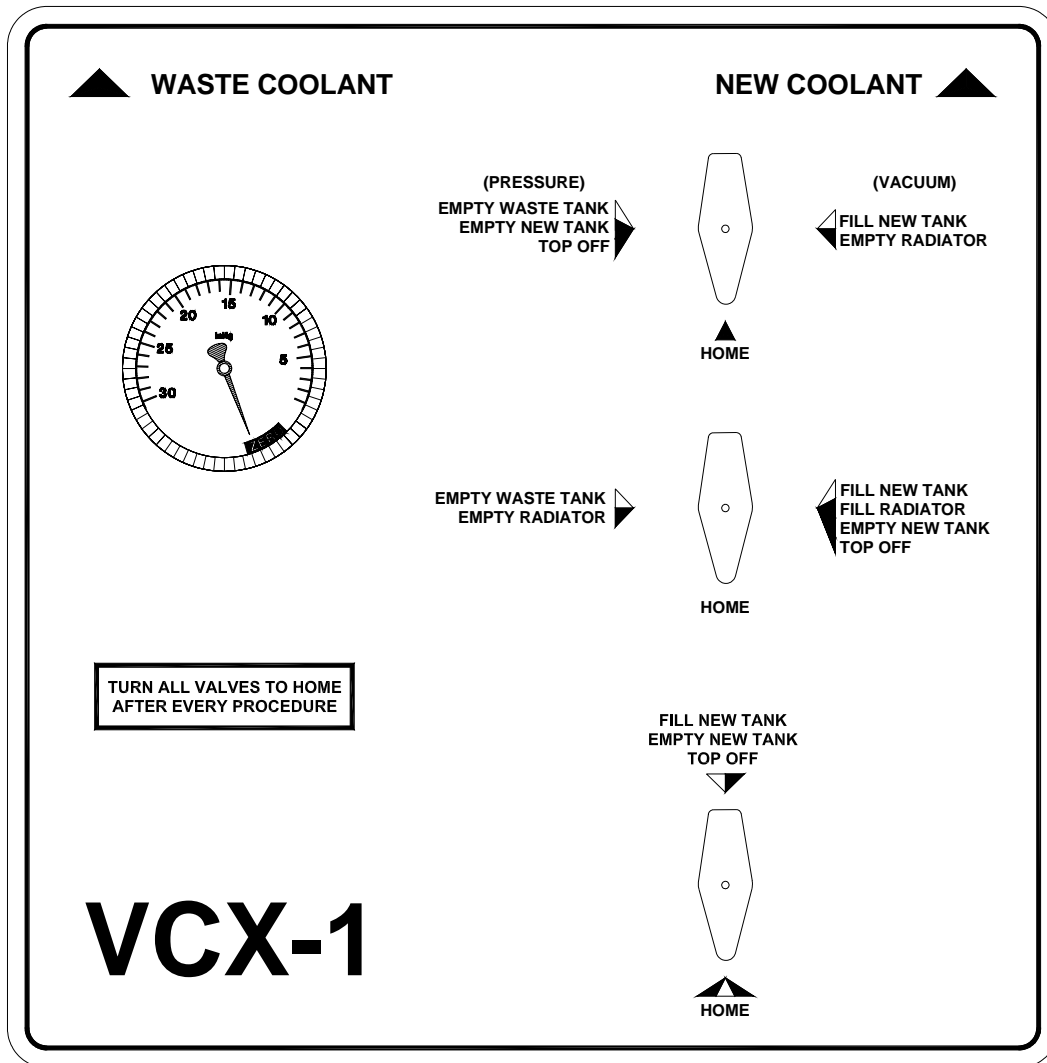

The above valve configuration is set before the VCX is connected to the shop air supply. This is also the position that the valves are returned to after each procedure. To select a procedure turn all of the valves to the colored triangle that corresponds with the desired procedure.

This illustration demonstrates the open and closed position on the Cone Adapter Valve. The **Cone Adapter Valve** closed position is 90 degrees clockwise from center.

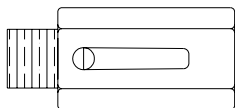

Valve Open

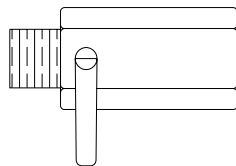

Valve Closed

Fill New Tank through Hose

1. Turn all panel valves to the Home position.
2. Connect shop air to VCX Shop Air Coupler.
3. Turn all panel valves to the Fill New Tank position as shown in the illustration below. This orientation can also be obtained by positioning the panel valves toward the green highlights closest to each valve.
4. Place the Cone Adapter, with the Adapter Hose attached, into the container of new coolant.
5. Raise the hose out of the container of new coolant when the desired fluid level is reached in the New Coolant Tank.
6. Close the Cone Adapter Valve.
7. Turn all valves to the Home position when done.

Note: DO NOT OVERFILL.

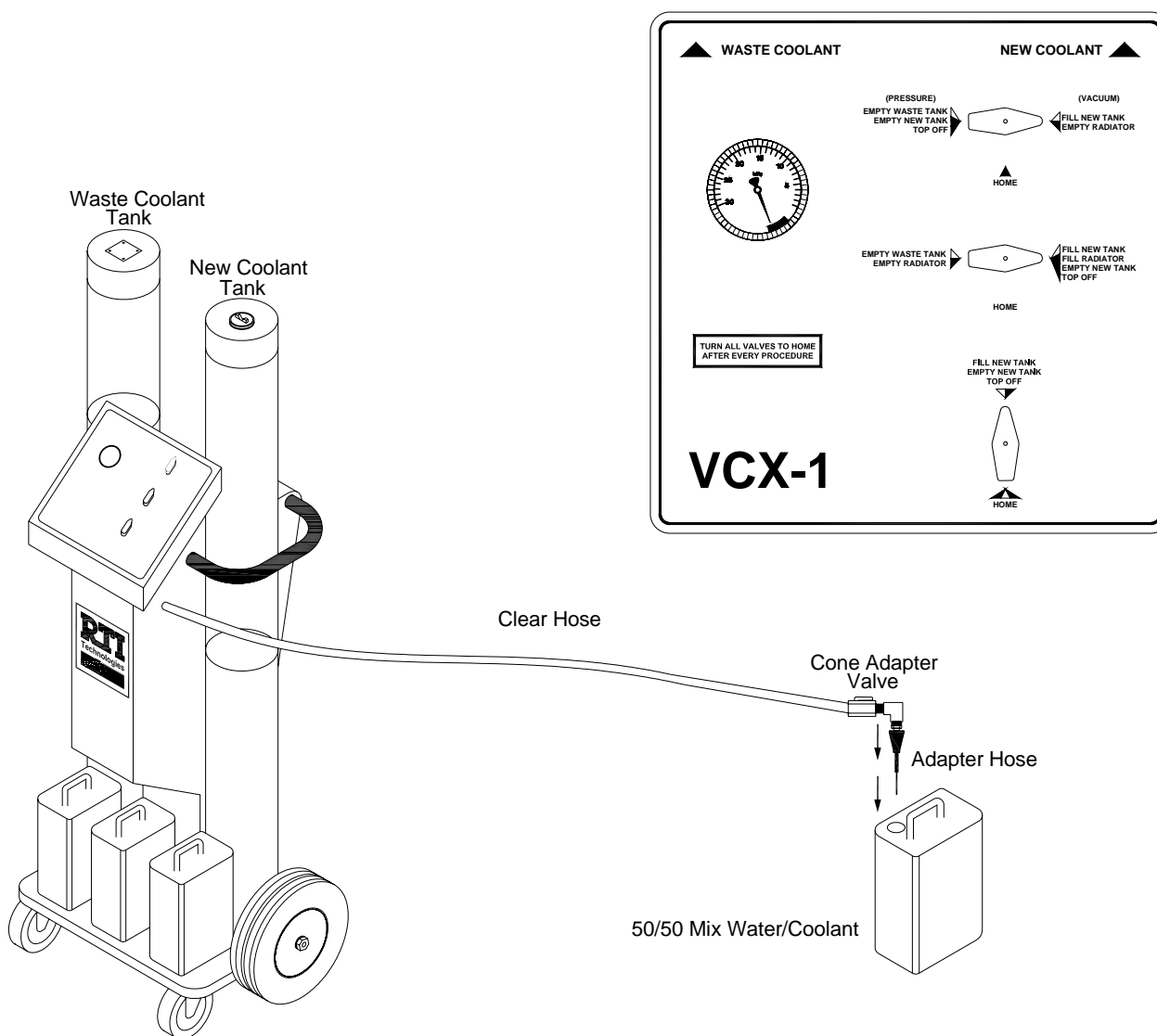

Fill New Tank through Fill Cap

1. Turn all panel valves to the Home position.
2. Remove New Coolant Fill Cap (turn counterclockwise).
3. Mix coolant and water for desired concentration.
4. Pour or dispense through New Coolant Tank Top.
5. Replace New Coolant Fill Cap (turn clockwise).

Note: DO NOT OVERFILL.

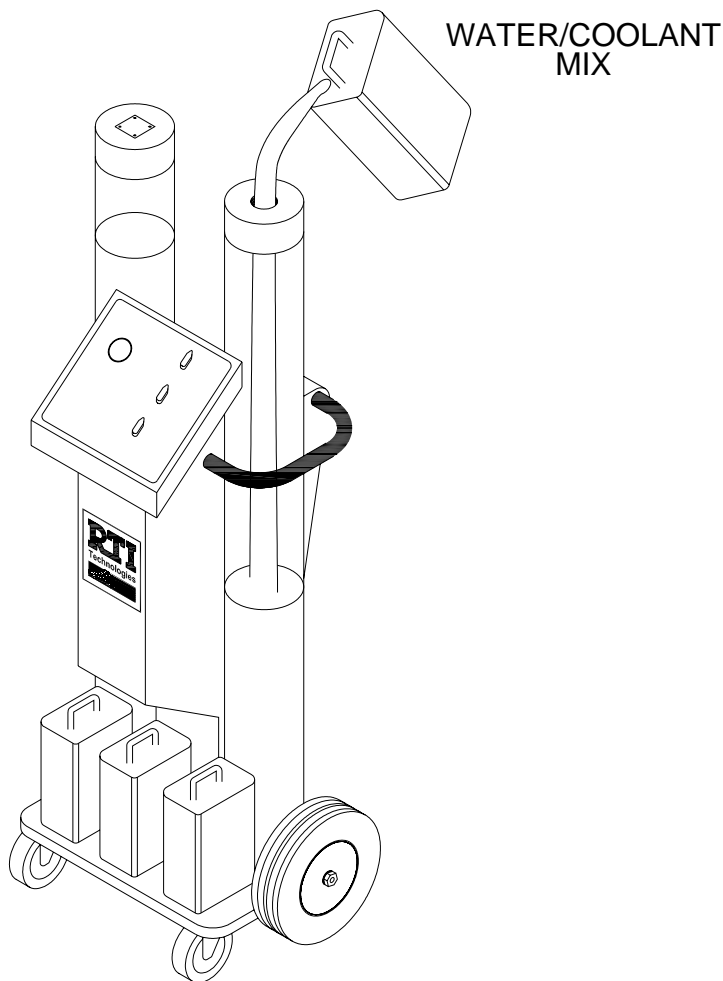

REMOVING CAP

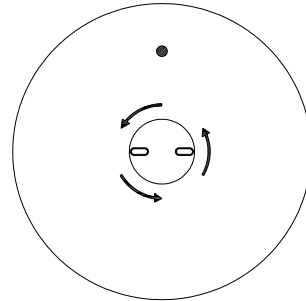

REPLACING CAP

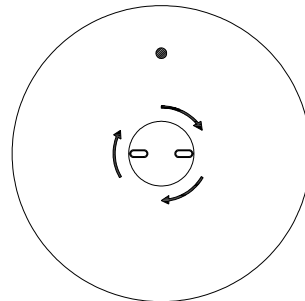

Empty Radiator

1. Run the vehicle with the heater turned on to bring the engine to operating temperature. Turn the engine off.
2. Turn all panel valves to the Home Position as shown on page 4.
3. Connect shop air to VCX Shop Air Coupler.
4. Turn all panel valves to the Empty Radiator position as shown in the illustration below. This orientation can also be obtained by positioning the panel valves toward the black highlights closest to each valve.
5. Insert the Adapter Hose into the Cone Adapter. Insert end of Adapter hose into overflow tank. Turn the Adapter Hose Valve to the open position to withdraw the coolant.

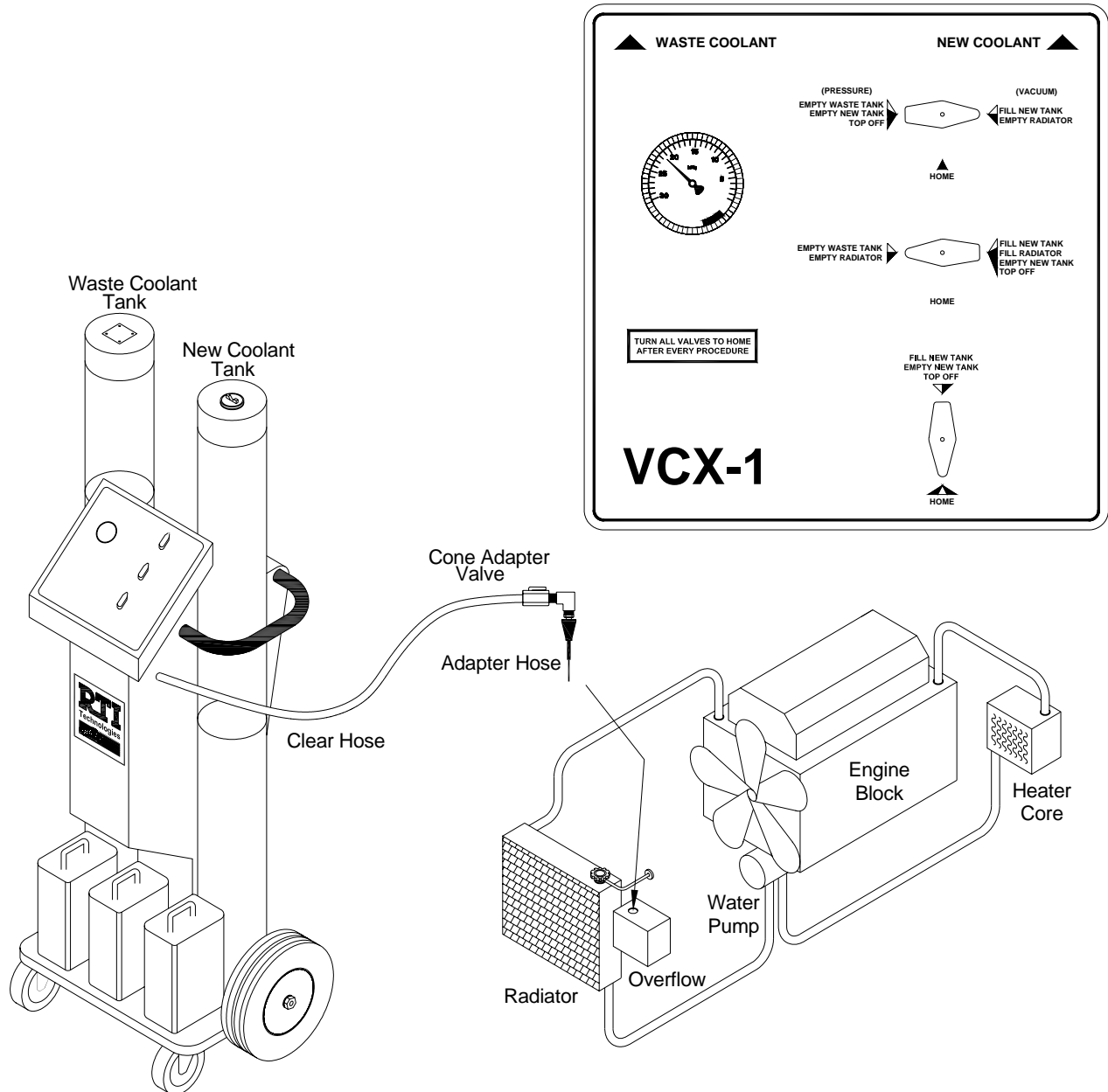

Empty Radiator (Continued)

6. **Carefully** remove radiator cap. Use a shop rag over the cap when removing to avoid injury in case there is still pressure.
7. Place VCX Cone Adapter snugly into the radiator spout. Do not force the Cone Adapter into the spout, the suction pressure from the VCX should secure it adequately. Verify that the Cone Adapter Valve is in the open position.
8. Start the engine once fluid starts to move through the clear hose and into the VCX Waste Coolant Tank. Verify that the System Vacuum gauge reads at least 22 InHg.
9. Once the waste coolant from the vehicle stops flowing through the clear hose, turn all of the panel valves to Home Position and **turn the engine off**.

DO NOT REMOVE CONE ADAPTER FROM THE RADIATOR!

Note: In some cases it may be necessary to pinch off the hose going from the radiator neck to the overflow container. This is only necessary when the vacuum leaks through this hose. The hose should be opened only after the Fill Radiator procedure.

WARNING
Do not overfill the Waste Tank.

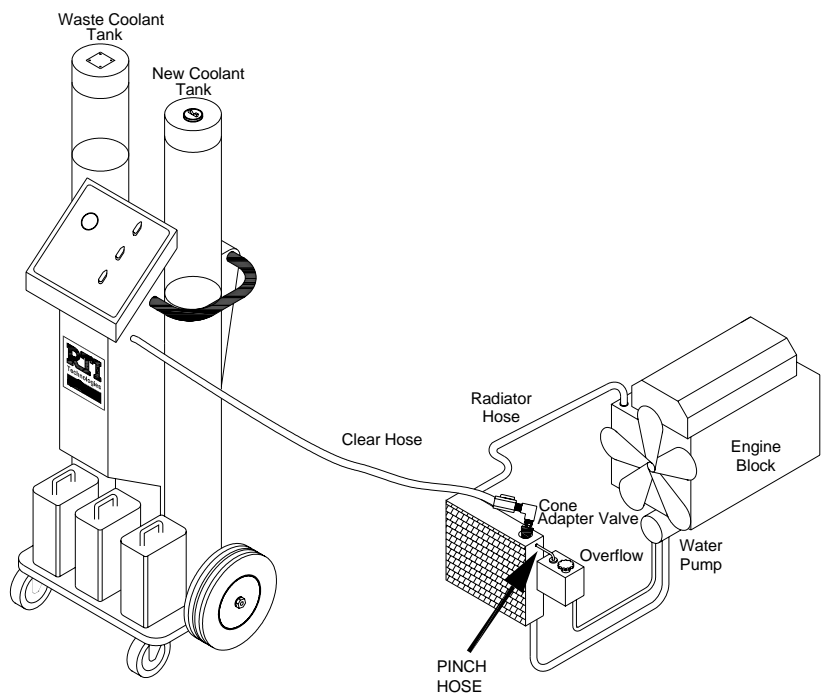

Special Hookups

Seal Tight Radiator

1. Insert the Adapter Hose into the end of the Cone Plug Adapter.
2. Place the Cone Adapter snugly into the radiator, coiling the excess length of Adapter Hose at the bottom.
3. Follow the Empty Radiator procedure steps 1-9.

More Effective Setup for Empty Radiator

During the Empty Radiator procedure clamp off the upper radiator hose and follow steps 1-9 of the Empty Radiator section.

Adapter Seal

1. In some cases it may be necessary to cut up to 0.75" off of the Cone Plug Adapter. This is only necessary when a tight seal can not be created due to bottoming out against the inside of a shallow radiator neck.
2. Take care to cut a clean edge free of loose debris.

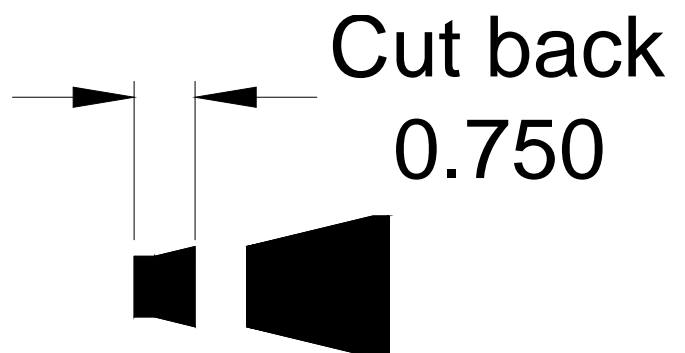
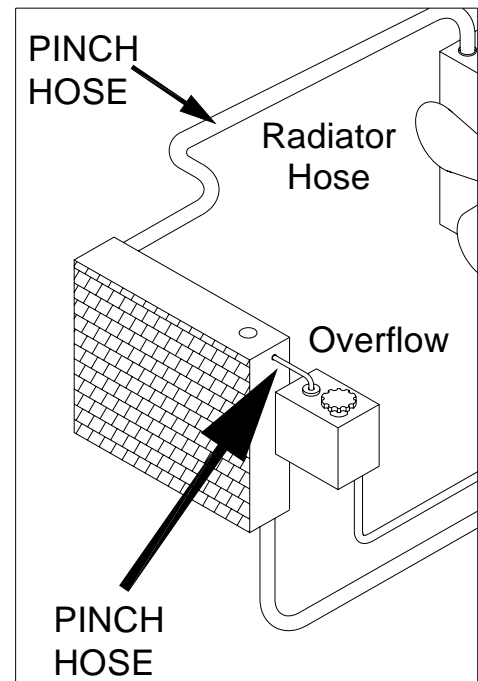

Fill Radiator

Fill Radiator

MAKE SURE THE ENGINE IS OFF

1. Turn all panel valves to the Home position.
2. Turn all panel valves to the Fill Radiator position shown in the illustration below, this orientation can also be obtained by positioning the panel valves toward the magenta highlights closest to each valve. Verify that the Cone Adapter Valve is open.
3. New coolant is automatically pulled out of the VCX New Coolant Tank and into the vehicle radiator through the clear hose.

NOTE: IF THE CONE ADAPTER BECOMES DISLODGED BEFORE YOU CAN BEGIN THIS PROCESS YOU MUST RERUN THE EMPTY RADIATOR FUNCTION, WITHOUT STARTING THE VEHICLE, TO REGAIN THE VACUUM NEEDED TO FILL THE VEHICLE COOLANT SYSTEM.

4. Once the coolant stops moving through the clear hose turn all of the panel valves back to the Home position and remove the Cone Adapter from the radiator.
5. Turn all valves to the Home position.
6. Close the Cone Adapter Valve.

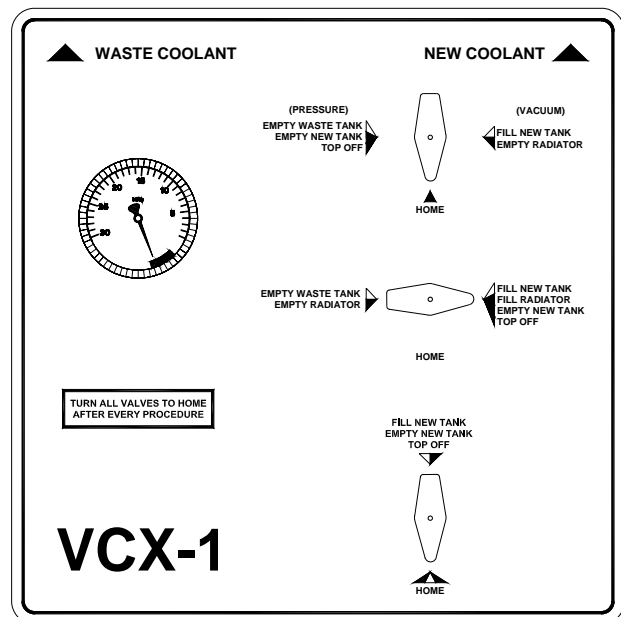

Top Off

1. Turn all panel valves to the Home position.
2. Turn the Cone Adapter Valve to the closed position.
3. Turn all panel valves to the Top Off position as shown in the illustration. This orientation can also be obtained by positioning the panel valves toward the blue highlights closest to each valve.
4. Open the Cone Adapter Valve to fill the radiator and overflow to the proper levels.
5. Turn all valves to the Home position.
6. Close the Cone Adapter valve when done.
7. Replace radiator and overflow caps.

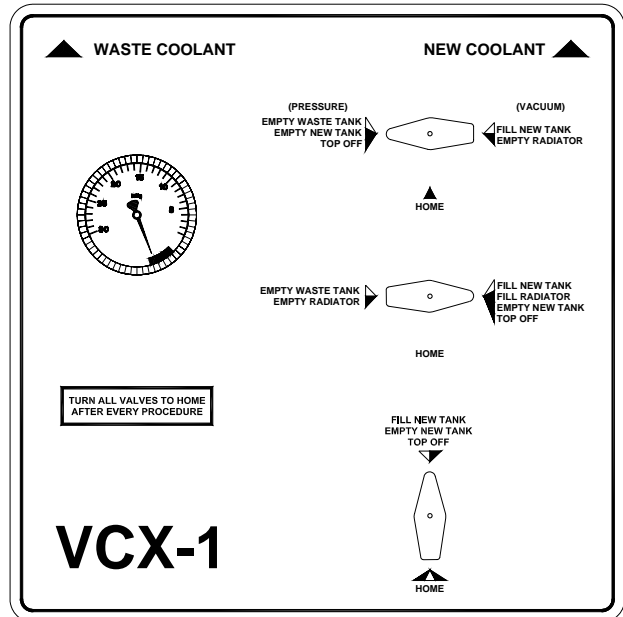

Flush Radiator

1. The New Coolant Tank needs to be filled with water. See Empty Waste Tank and Fill New Tank procedures.
2. The Empty Radiator function must be run to completion.
3. Run the Fill Radiator procedure.
4. The Empty Radiator function must be run again to extract all of the water inside the cooling system.
5. Repeat steps 3 and 4 until the desired results are achieved. Once completed new coolant needs to be added to the vehicle system.

Empty Waste Tank

1. Turn all panel valves to the Home position.
2. Connect shop air to VCX Shop Air Coupler.
3. Close Cone Adapter Valve.
4. Turn all panel valves to the Empty Waste Tank position shown in the illustration below. This orientation can also be obtained by positioning the panel valves toward the red highlights closest to each valve.
5. Place the end of the clear hose into a bulk waste container and open the Cone Adapter Valve.
6. Waste coolant will begin leaving the VCX from the Waste Coolant Tank through the clear hose. Be cautious not to spill waste coolant onto the floor as the hose may “jump” when the Waste Coolant Tank is nearing empty. Clean up any spills that may occur immediately.
7. Once the Waste Coolant Tank is empty, close the Cone Adapter Valve and turn all valves to the Home position.

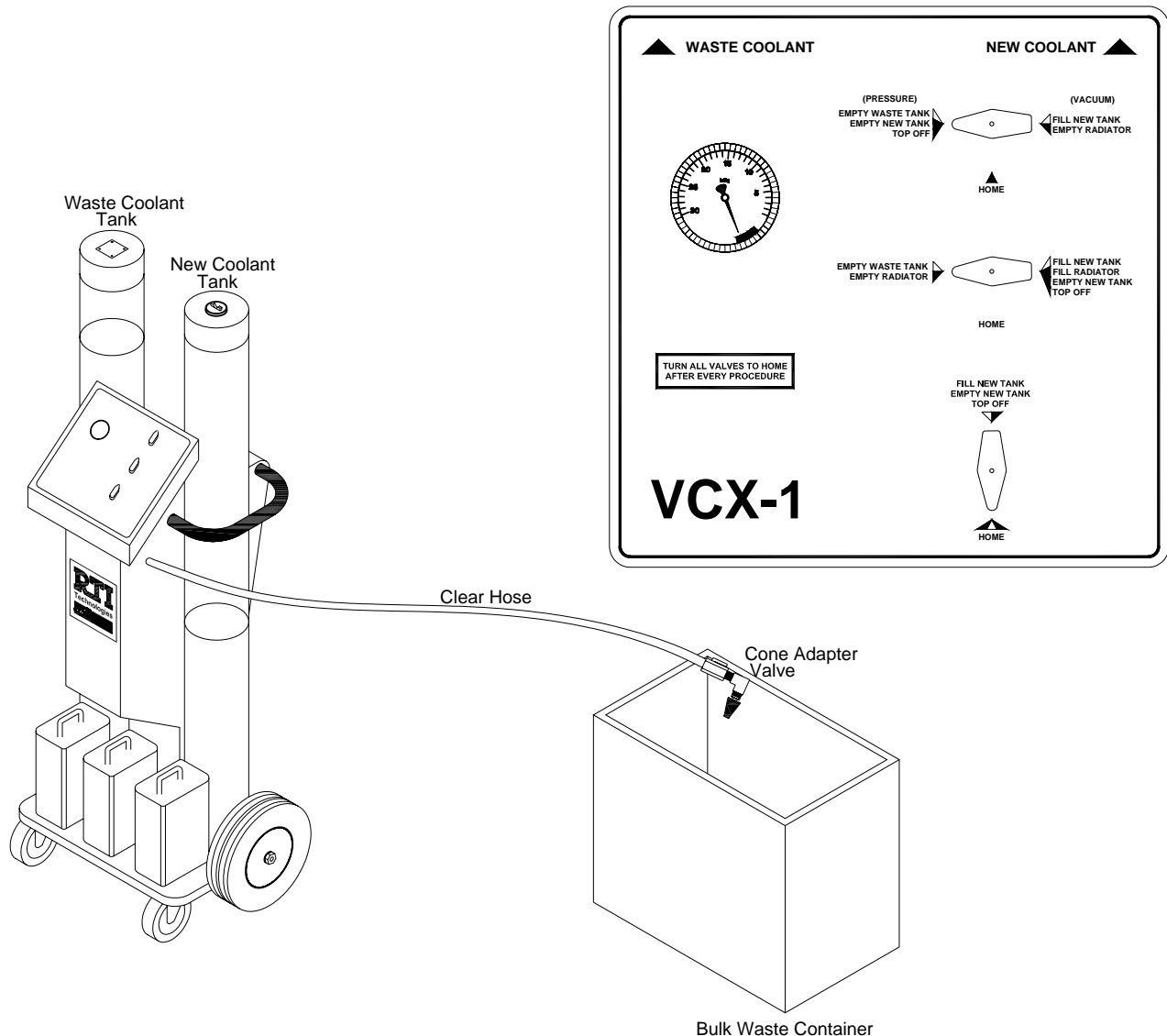

Empty New Tank

1. Turn all panel valves to the Home position.
2. Connect shop air to VCX Shop Air Coupler.
3. Close Cone Adapter Valve.
4. Turn all panel valves to the Empty New Tank position shown in the illustration below. This orientation can also be obtained by positioning the panel valves toward the blue highlights closest to each valve.
5. Place the end of the clear hose into a bulk storage container and open the Cone Adapter Valve.
6. Coolant will begin leaving the VCX from the New Coolant Tank through the clear hose. Be cautious not to spill coolant onto the floor as the hose may “jump” when the New Coolant Tank is nearing emptiness. Clean up any spills that may occur immediately.
7. Once the Waste Coolant Tank is empty, close the Cone Adapter Valve and turn all valves to the Home position.

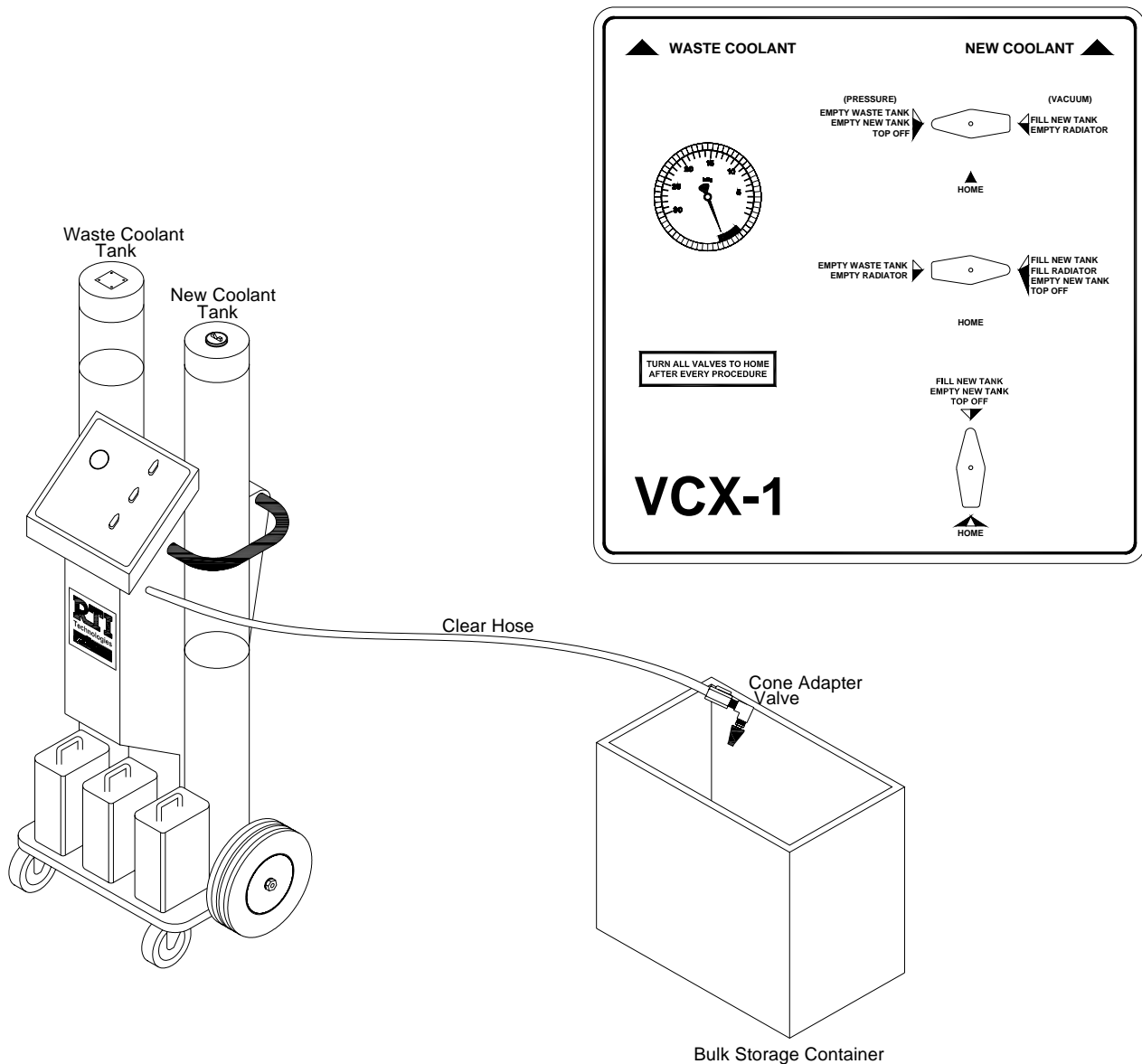

Troubleshooting

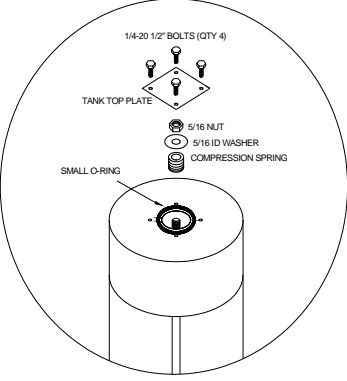
Problem	Solution
Vacuum becomes weak	<p>Inside of the VCX, there is a venturi vacuum generator that may have collected debris during the operation of the unit. If this occurs, the vacuum will become weak resulting in a lower vacuum reading on the System Vacuum gauge and poor performance. Remove the venturi from the line and blow shop air through it. Use the Parts Identification (page 12) to locate the venturi. Reconnect to correct lines when done.</p>
	<p>There may be a vacuum leak at either the top or bottom sealing point on the tanks. Fill the tank to the top with water and turn all valves to the Home position. Close the Cone Adapter Valve and turn all valves to the Empty (leaking tank) position. Check for leaks and tighten, replace or repair as necessary.</p>
Leakage 	<p>The hex nut at the top of the tank may be loose. Tighten no more than 1/4 turn past the factory setting. Caution, over tightening the hex nut can lessen the integrity of the tank, cause the tension spring to fail or damage the o-rings (see illustration).</p>
	<p>Debris may have collected at the bottom of the tank. Disassemble tank and clean the base of tank. Take care when reassembling not to over tighten the hex nut. Turn nut ONLY three revolutions past finger tight. Check for leaks and turn in 1/4 turns as necessary.</p>
	<p>Over time, the o-ring at the bottom or top of the cylinder may become worn. Inspect and replace if needed.</p>
Tank Overflow	<p>If fluid is ever filled to the top of the tank while using the unit there is a device that will release excess to the inside of the cabinet.</p>
External Clear Hose	<p>Using the VCX to remove coolant from a vehicle creates high temperatures throughout the unit particularly where the clear hose connects to the Cone Adapter. Repeated exposure to these temperatures may cause deterioration of the hose. If possible cut affect area off and reconnect Cone Adapter. If replacement of the hose is required call RTI for a new one.</p>

Parts Identification

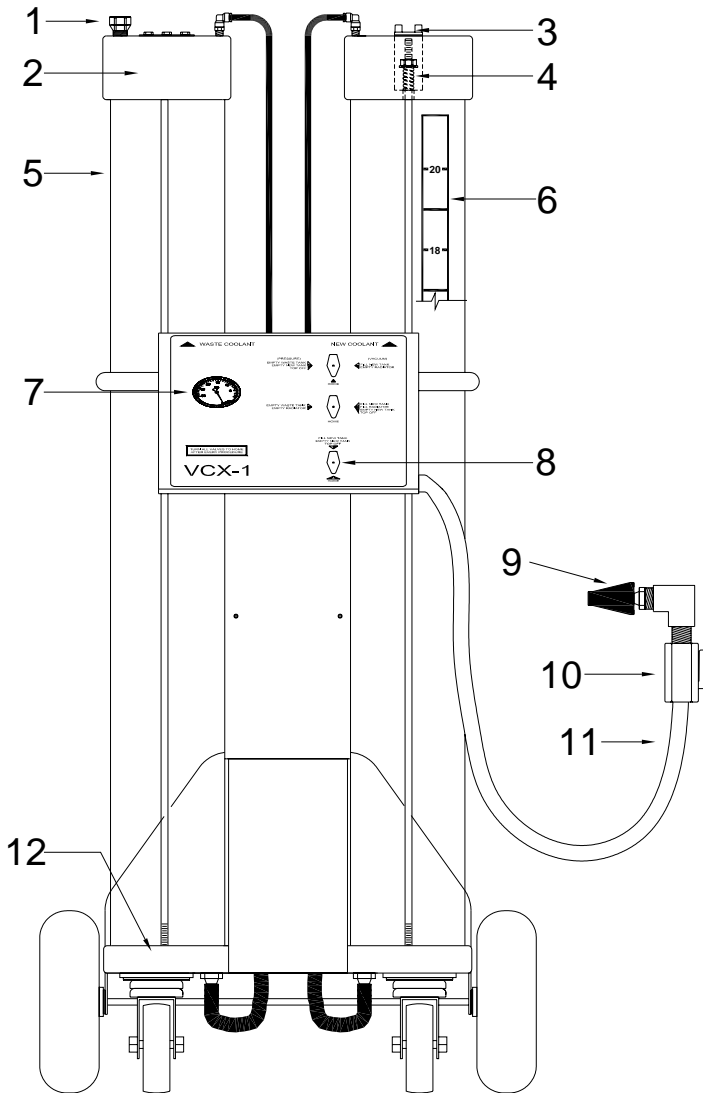

	P/N	Description
1	022-80115-00	Valve Relief 1/4 MPT X 1/4 FPT
2	060-81252-00 028-80236-00 028-80228-00	Top Cylinder Plate Large O-Ring Small O-Ring
3	028-80348-00	Plug Plastic 1.5"-12
4	040-80196-00	Compression Spring
5	370-80174-00	Acrylic Tube with Decal
6	035-81010-00	Tank Level Decal (VCX-1)
7	026-80238-00	Vacuum Gauge 30"-0 PSIG
8	022-80028-00	Ball Valve 3-Way 1/4 FPT (BHD)
9	060-81215-00	Cone Plug Adapter
10	370-80168-00	Cone Adapter Valve Assy
11	370-80110-00	Clear Hose Assy
12	060-81251-00 028-80236-00	Bottom Cylinder Plate Large O-Ring
13	370-80102-00	Vacuum Pump (Venturi)
14	370-80075-00	Pressure Regulator 1/4 FPT X 1/4 FPT (BHD)
15	370-80095-00	Adapter Hose with Radiator Cap Relief

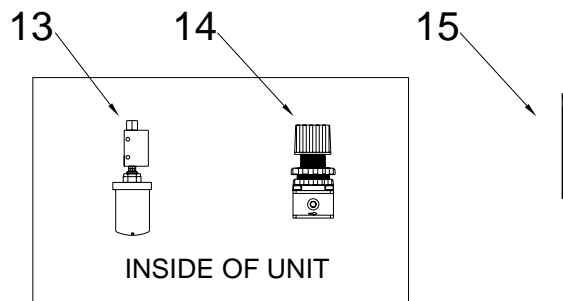

Flow

